

- RF Transformer
- Impedance=75Ω
- Operating Temperature Range: -40℃ to 85℃
- Storage Temperature Range: -55℃ to 100℃
- RoHS Compliant



| Electrical Specifications @25°C,Z <sub>0</sub> =75Ω |                  |                |            |            |            |          |            |
|---|------------------|----------------|------------|------------|------------|----------|------------|
| Part Number   | Ω Ratio          | Insertion Loss |            |            | DC Current | RF Power | Frquency   |
|   | Pri:Sec(6-4:1-3) | 5-100MHz       | 0.6-300MHz | 0.4-500MHz |            |          |            |
| RFT-046SG   | 1:1              | 0.8dB Max      | 2.0dB Max  | 3.0dB Max  | 30mA       | 0.25W    | 0.4-500MHz |

| Return Loss         |                     | Amplitude Unbalance |            | Phase Unbalance |            |
|---------------------|---------------------|---------------------|------------|-----------------|------------|
| 1-100MHz            | 0.5-300MHz          | 1-100MHz            | 0.5-300MHz | 1-100MHz        | 0.5-300MHz |
| 13dB Min (19dB Typ) | 10dB Min (15dB Typ) | 0.6dB Max           | 0.8dB Max  | 4° Max          | 8° Max     |

Note:Insertion Loss is referenced to mid-band loss0.5dB typ.

## MECHANICAL

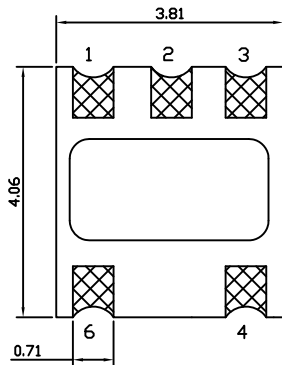

Top View

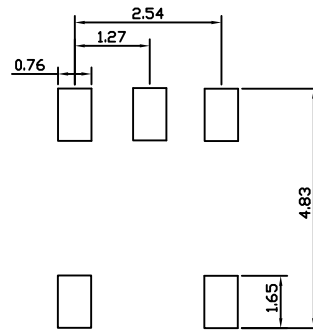

Recommended PAD Layout

Top View

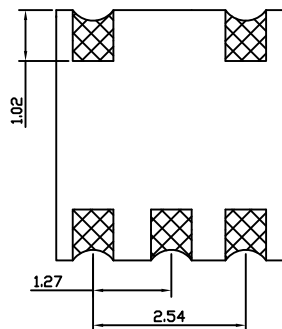

Bottom View

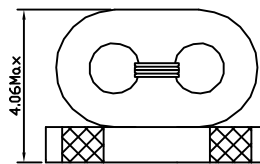

Front View

Unless otherwise specified all tolerances are:±0.25 in mm

## SCHEMATICS

