





-  Meets IEEE 802.3 Standards.
-  Designed For 1000 BASE-T Applications, Surface Mount Type.
-  Operating Temperature Range: -40°C to +85°C.
-  RoHS Compliant.

Part Number	Electrical Specifications @25°C						
	Turns Ratio (±5%)	OCL(μH Min) @100KHz,0.1V With 8mA DC Bias	CWW(pF Max) @100KHz,0.1V	DCR (Ω Max)	Insertion Loss (dB Max)	Return Loss (dB Min)	HI-POT (Vrms)
GB010G00	1CT:1CT	150	35	3.5	-1.5@0.5-100MHz	-18@0.5-40MHz -12+20*Log(F/80)@40.1-100MHz	1500

MECHANICAL

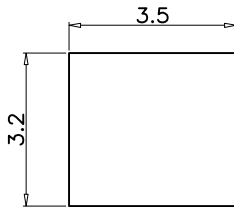

TOP VIEW

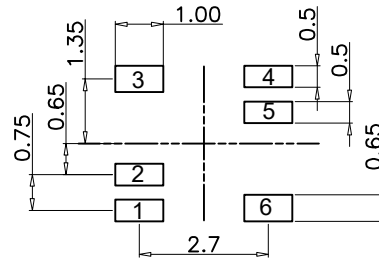

SUGGEST LAYOUT

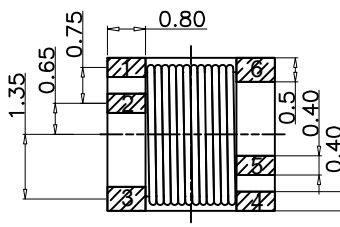

BOTTOM VIEW

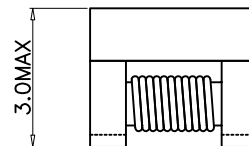

FRONT VIEW

Unless otherwise specified all tolerances are: ±0.25 in mm

SCHEMATICS

