





-  Meets IEEE 802.3bt Standards.
-  Designed For 10G BASE-T Applications, Surface Mount Type.
-  Operating Temperature Range: -40 °C to +125 °C. (Including temperature rise)
-  RoHS Compliant.
-  1A Current Capability.

Part Number	Electrical Specifications @25°C						
	Turns Ratio (±5%)	OCL(μH Min) @100KHz,0.1V With 15mA DC Bias	CWW(pF Max) @100KHz,0.1V	DCR (Ω Max)	Insertion Loss (dB Max)	Return Loss (dB Min)	HI-POT (Vrms)
MC021G00	1CT:1CT	120	35	0.8	-0.5@1-65MHz -0.8@65-125MHz -2.0@125-400MHz -4.5@400-500MHz	-25@1-100MHz -20.5+20.75*LOG(F/40)@100-250MHz -12@200-300 -9.5@300-400 -7.5@400-500	1500

## MECHANICAL

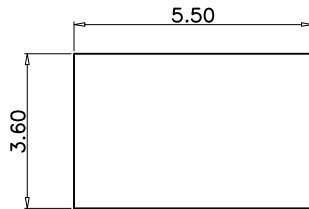

TOP VIEW

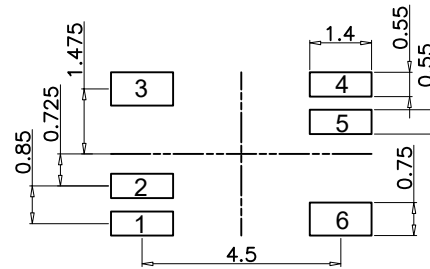

SUGGEST LAYOUT

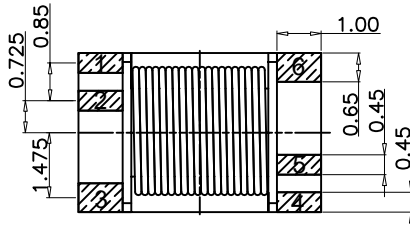

BOTTOM VIEW

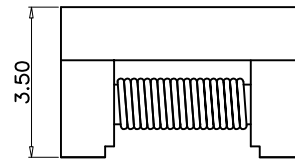

FRONT VIEW

Unless otherwise specified all tolerances are:±0.25 in mm

## SCHEMATICS

